



南亞塑膠

NAN YA PLASTICS

2、美标管件 UPVC /CPVC FITTINGS (ANSI)

执行标准: ASTM D2467 (SCH80) ASTM F439

Conform to: ASTM D2467 (SCH80) ASTM F439

90° 弯头 90° ELBOW (S×S) ANSI

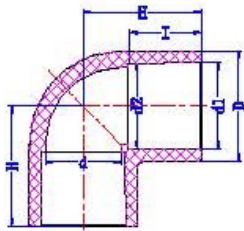

Nominal SIZE	Socket Type			Structural Diameter		
	d1	d2	I	D	d	H
1/2"	21.54	21.23	24.00	29.20	16.00	34.80
3/4"	26.87	26.57	27.00	34.90	22.00	40.90
1"	33.55	33.27	30.00	43.00	30.00	47.00
1-1/4"	42.42	42.04	34.00	52.30	38.00	54.25
1-1/2"	48.56	48.11	37.00	58.90	43.00	60.90
2"	60.63	60.17	40.00	71.90	54.00	70.10
2-1/2"	73.38	72.85	46.50	87.50	67.00	82.95
3"	89.31	88.70	50.00	104.75	82.00	93.60
4"	114.76	114.10	60.00	132.00	106.00	115.65
5"	141.81	141.10	69.00	162.30	133.00	150.00
6"	168.83	168.00	78.00	190.80	158.00	174.50
8"	219.84	218.70	102.00	245.30	200.00	226.00

45° 弯头 45° ELBOW (S×S) ANSI

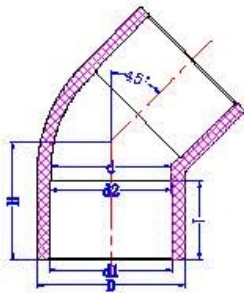

Nominal SIZE	Socket Type			Structural Diameter		
	d1	d2	I	D	d	H
1/2"	21.54	21.23	24.00	29.20	16.00	30.20
3/4"	26.87	26.57	27.00	34.90	22.00	36.30
1"	33.55	33.27	30.00	43.00	30.00	41.00
1-1/4"	42.42	42.04	34.00	52.30	38.00	46.40
1-1/2"	48.56	48.11	37.00	58.90	43.00	52.30
2"	60.63	60.17	40.00	71.90	54.00	59.80
2-1/2"	73.38	72.85	46.50	87.50	67.00	70.00
3"	89.31	88.70	50.00	104.75	82.00	78.30
4"	114.76	114.10	60.00	132.00	106.00	96.30
5"	141.81	141.10	69.00	162.30	133.00	108.00
6"	168.83	168.00	78.00	190.80	158.00	132.30
8"	219.84	218.70	102.00	245.30	200.00	183.20



正三通 TEE (S×S) ANSI

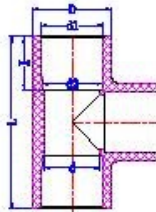

Nominal SIZE	Socket Type			Structural Diameter		
	d1	d2	I	D	d	L
1/2"	21.54	21.23	24.00	29.20	16.00	70.00
3/4"	26.87	26.67	27.00	34.90	22.00	82.00
1"	33.65	33.27	30.00	43.00	30.00	94.00
1-1/4"	42.42	42.04	34.00	52.30	36.00	108.50
1-1/2"	48.56	48.11	37.00	58.90	43.00	122.00
2"	60.63	60.17	40.00	71.90	54.00	140.00
2-1/2"	73.38	72.85	46.50	87.60	67.00	166.00
3"	89.31	88.70	50.00	104.75	82.00	187.00
4"	114.76	114.10	60.00	132.00	106.00	231.00
5"	141.81	141.00	69.00	162.30	133.00	307.00
6"	169.83	169.00	79.00	190.30	158.00	336.00
8"	219.84	218.70	102.00	246.30	200.00	434.00

异径三通 REDUCER TEE (S×S×S) ANSI

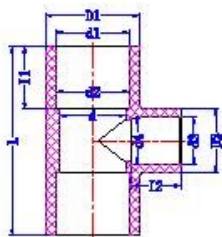

Nominal SIZE	Socket Type						Structural Diameter			
	d1	d2	I1	d3	d4	I2	D1	D2	d	L
3/4"×1/2"	26.87	26.67	27.00	21.54	21.23	24.00	35.00	30.00	22.00	75.80
1"×1/2"	33.65	33.27	30.00	21.54	21.23	24.00	44.00	30.00	30.00	87.00
1"×3/4"	33.65	33.27	30.00	26.87	26.67	27.00	44.00	35.00	30.00	87.00
1-1/4"×1/2"	42.42	42.04	34.00	21.54	21.23	24.00	54.00	30.00	38.00	100.00
1-1/4"×3/4"	42.42	42.04	34.00	26.87	26.67	27.00	54.00	35.00	38.00	100.00
1-1/4"×1"	42.42	42.04	34.00	33.65	33.27	30.00	54.00	44.00	38.00	100.00
1-1/2"×1/2"	48.56	48.11	37.00	21.54	21.23	24.00	60.00	30.00	44.00	108.60
1-1/2"×3/4"	48.56	48.11	37.00	26.87	26.67	27.00	60.00	35.00	44.00	108.50
1-1/2"×1"	48.56	48.11	37.00	33.65	33.27	30.00	60.00	44.00	44.00	108.60
1-1/2"×1-1/4"	48.56	48.11	37.00	42.42	42.04	34.00	60.00	54.00	44.00	108.60
2"×1/2"	60.63	60.17	41.00	21.54	21.23	24.00	73.00	30.00	54.00	113.00
2"×3/4"	60.63	60.17	41.00	26.87	26.67	27.00	73.00	35.00	54.00	113.00
2"×1"	60.63	60.17	41.00	33.65	33.27	30.00	73.00	44.00	54.00	113.00
2"×1-1/4"	60.63	60.17	41.00	42.42	42.04	34.00	73.00	54.00	54.00	129.00
2"×1-1/2"	60.63	60.17	41.00	48.56	48.11	37.00	73.00	60.00	54.00	129.00
2-1/2"×1"	73.38	72.85	46.50	33.65	33.27	30.00	88.00	44.00	67.00	154.00
2-1/2"×1-1/4"	73.38	72.85	46.50	42.42	42.04	34.00	88.00	54.00	67.00	154.00
2-1/2"×1-1/2"	73.38	72.85	46.50	48.56	48.11	37.00	88.00	60.00	67.00	154.00
2-1/2"×2"	73.38	72.85	46.50	60.63	60.17	41.00	88.00	73.00	67.00	154.00
3"×1-1/2"	89.31	88.70	50.00	48.56	48.11	37.00	105.00	60.00	82.00	172.00
3"×2"	89.31	88.70	50.00	60.63	60.17	41.00	105.00	73.00	82.00	172.00
3"×2-1/2"	89.31	88.70	50.00	73.38	72.85	46.50	105.00	88.00	82.00	172.00
4"×1-1/2"	114.76	114.10	60.00	48.56	48.11	37.00	132.00	60.00	106.00	208.00
4"×2"	114.76	114.10	60.00	60.63	60.17	41.00	132.00	73.00	106.00	208.00
4"×2-1/2"	114.76	114.10	60.00	73.38	72.85	46.50	132.00	88.00	106.00	208.00
4"×3"	114.76	114.10	60.00	89.31	88.70	50.00	132.00	105.00	106.00	208.00



南亞塑膠

NANYA PLASTICS

直接 COUPLING (S×S) ANSI

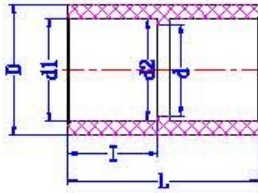

Nominal SIZE	Socket Type			Structural Diameter		
	d1	d2	I	D	d	L
1/2"	21.54	21.23	24.00	29.20	16.00	49.60
3/4"	26.87	26.57	27.00	34.90	22.00	55.80
1"	33.65	33.27	30.00	43.00	30.00	62.00
1-1/4"	42.42	42.04	34.00	52.30	38.00	68.50
1-1/2"	48.56	48.11	37.00	58.90	43.00	76.00
2"	60.63	60.17	40.00	71.90	54.00	83.00
2-1/2"	73.38	72.85	46.50	87.60	67.00	97.00
3"	89.31	88.70	50.00	104.75	82.00	104.00
4"	114.76	114.10	60.00	132.00	106.00	126.00
5"	141.81	141.00	69.00	162.30	133.00	143.00
6"	168.83	169.00	79.00	190.80	158.00	168.00
8"	219.84	218.70	105.00	246.30	200.00	215.00

异径直接 REDUCER COUPLING (S×S) ANSI

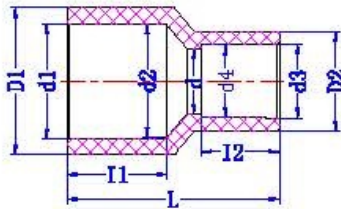

Nominal SIZE	Socket Type						Structural Diameter			
	d1	d2	I1	d3	d4	I2	D1	D2	d	L
3/4"×1/2"	26.87	26.57	27.00	21.54	21.23	24.00	35.00	30.00	22.00	56.00
1"×1/2"	33.65	33.27	30.00	21.54	21.23	24.00	44.00	30.00	30.00	62.00
1"×3/4"	33.65	33.27	30.00	26.87	26.57	27.00	44.00	35.00	30.00	62.00
1-1/4"×1/2"	42.42	42.04	34.00	21.54	21.23	24.00	54.00	30.00	38.00	68.00
1-1/4"×3/4"	42.42	42.04	34.00	26.87	26.57	27.00	64.00	35.00	38.00	68.00
1-1/4"×1"	42.42	42.04	34.00	33.65	33.27	30.00	64.00	44.00	38.00	68.00
1-1/2"×1/2"	48.56	48.11	37.00	21.54	21.23	24.00	60.00	30.00	44.00	74.00
1-1/2"×3/4"	48.56	48.11	37.00	26.87	26.57	27.00	60.00	35.00	44.00	74.00
1-1/2"×1"	48.56	48.11	37.00	33.65	33.27	30.00	60.00	44.00	44.00	74.00
1-1/2"×1-1/4"	48.56	48.11	37.00	42.42	42.04	34.00	60.00	54.00	44.00	74.00
2"×1/2"	60.63	60.17	41.00	21.54	21.23	24.00	73.00	30.00	54.00	76.00
2"×3/4"	60.63	60.17	41.00	26.87	26.57	27.00	73.00	35.00	54.00	76.00
2"×1"	60.63	60.17	41.00	33.65	33.27	30.00	73.00	44.00	54.00	76.00
2"×1-1/4"	60.63	60.17	41.00	42.42	42.04	34.00	73.00	54.00	54.00	82.00
2"×1-1/2"	60.63	60.17	41.00	48.56	48.11	37.00	73.00	60.00	54.00	82.00
2-1/4"×1-1/4"	73.38	72.85	46.50	42.42	42.04	34.00	88.00	54.00	67.00	92.00
2-1/4"×1-1/2"	73.38	72.85	46.50	48.56	48.11	37.00	88.00	60.00	67.00	92.00
2-1/4"×2"	73.38	72.85	46.50	60.63	60.17	41.00	88.00	73.00	67.00	92.00
3"×1-1/2"	89.31	88.70	50.00	48.56	48.11	37.00	105.00	60.00	82.00	102.00
3"×2"	89.31	88.70	60.00	60.63	60.17	41.00	105.00	73.00	82.00	102.00
4"×1-1/2"	114.76	114.10	60.00	48.56	48.11	37.00	132.00	60.00	106.00	106.00
4"×2"	114.76	114.10	60.00	60.63	60.17	41.00	132.00	73.00	106.00	106.00
4"×2-1/2"	114.76	114.10	60.00	73.38	72.85	46.50	132.00	88.00	106.00	116.00
4"×3"	114.76	114.10	60.00	89.31	88.70	50.00	132.00	105.00	106.00	116.00



南亞塑膠

NAN YA PLASTICS

外牙接头 MALE ADAPTER (S×T) ANSI

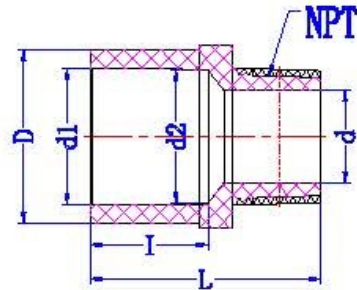
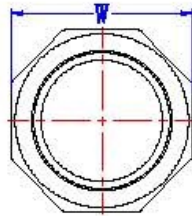

Nominal	Outside Dia	Socket Type			Structural Diameter			
SIZE	D	d1	d2	I	W	d	L	NPT(牙/寸)
1/2"	29.20	21.54	21.23	22.80	31.00	13.20	46.50	14
3/4"	34.90	26.87	26.67	26.90	37.00	19.00	49.40	14
1"	43.00	33.65	33.27	29.20	45.00	24.00	56.60	11.5
1-1/4"	62.90	42.42	42.04	32.25	65.00	32.00	58.60	11.5
1-1/2"	61.00	48.66	48.11	36.40	84.20	38.00	65.60	11.5
2"	75.00	60.63	60.17	38.60	78.20	60.00	70.30	11.5

内牙接头 FEMALE ADAPTER (S×T) ANSI

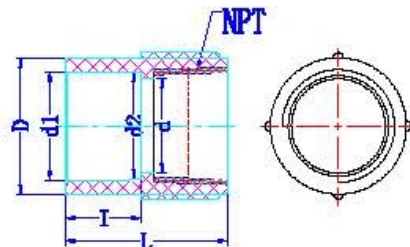

Nominal	Outside Dia	Socket Type			Structural Diameter			
SIZE	D	d1	d2	I	d	L	NPT(牙/寸)	
1/2"	30.00	21.54	21.23	24.00	13.20	44.00	14	
3/4"	35.00	26.87	26.67	27.00	19.00	60.00	14	
1"	44.00	33.65	33.27	30.00	24.00	65.00	11.5	
1-1/4"	64.00	42.42	42.04	34.00	32.00	62.00	11.5	
1-1/2"	60.00	48.66	48.11	37.00	38.00	67.00	11.5	
2"	73.00	60.63	60.17	40.00	50.00	73.00	11.5	



补芯 REDUCER BUSHING (S×S) ANSI



Nominal SIZE	Outside D	Socket Type		Structural Diameter	
		d1	d2	d	L
3/4"×1/2"	26.67	21.54	21.23	17.00	35.00
1"×3/4"	33.40	26.97	26.67	22.50	36.00
1-1/4"×1"	42.15	33.65	33.27	29.00	42.00
1-1/2"×1-1/4"	48.26	42.42	42.04	39.00	45.00
2"×1-1/2"	60.33	48.56	48.11	42.00	53.00
2-1/1"×2"	73.03	60.63	60.17	54.00	56.50
3"×2"	88.90	60.63	60.17	64.00	60.00
3"×2-1/2"	88.90	73.38	72.85	66.00	60.00
4"×2-1/2"	114.30	73.38	72.85	65.00	72.00
4"×3"	114.30	89.31	88.70	80.00	72.00
6"×4"	141.30	114.76	114.10	97.10	85.00
6"×4"	168.28	114.76	114.10	97.10	92.50
6"×5"	168.28	141.81	141.00	121.00	92.50
8"×4"	219.08	114.76	114.10	97.10	120.00
8"×6"	219.08	168.83	168.00	148.00	120

管帽 CAP ANSI

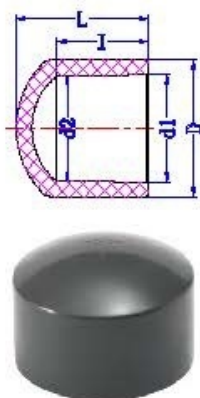

Nominal SIZE	Socket Type			Structural Diameter	
	d1	d2	I	D	L
1/2"	21.54	21.23	24.00	30.00	35.00
3/4"	26.97	26.67	27.00	35.00	36.50
1"	33.65	33.27	30.00	44.00	42.00
1-1/4"	42.42	42.04	34.00	54.00	45.00
1-1/2"	48.56	48.11	37.00	60.00	50.50
2"	60.63	60.17	40.00	73.00	55.00
2-1/2"	73.38	72.85	46.50	85.00	67.50
3"	89.31	88.70	50.00	105.00	71.00
4"	114.76	114.10	60.00	132.00	82.00



单片法兰 FLANGE ANSI

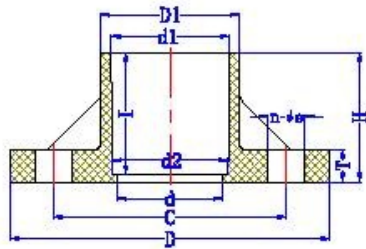

SIZE	D	D1	C	d	d1	d2	H	T	I	n-φe
1/2"	89	33	60.50	15	21.54	21.23	35	14	30.0	4-16
3/4"	99	35	69.90	20	26.87	26.57	40	15	35.0	4-16
1"	106	43	79.50	25	33.65	33.27	45	16	40.0	4-16
1-1/4"	116	52	89.00	32	42.42	42.04	49	18	44.0	4-16
1-1/2"	127	59	98.50	43	48.58	48.11	59	18	35.0	4-16
2"	153	75	120.70	55	60.63	60.17	45	20	38.30	4-19
2-1/2"	178	89	139.70	65	73.38	72.85	70	20	44.5	4-19
3"	191	106	153.40	80	89.31	88.70	73	20	55.0	4-19
4"	230	132	190.50	100	114.76	114.10	56	22	57.30	8-19
5"	254	162	215.90	125	141.81	141.00	86	24	78.00	8-22
6"	279	185	241.30	150	168.83	168.00	91	25	76.20	8-22
8"	343	246	298.50	200	219.84	218.70	117	28	101.6	8-22

双片式法兰 VAN STONE FLANGE ANSI

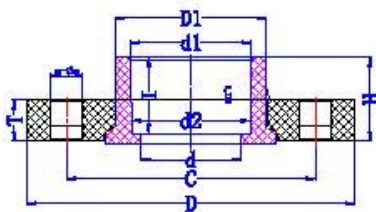

SIZE	D	D1	C	d	d1	d2	H	T	I	n-φe
1/2"	96	30.8	60.45	15	21.54	21.23	26.0	14	21.6	4-15
3/4"	105	36.0	69.85	20	26.87	26.57	29.5	15	23.4	4-15
1"	125	43.8	79.25	25	33.65	33.27	32.2	16	28.7	4-19
1-1/4"	140	52.6	88.90	32	42.42	42.04	36.5	16	31.7	4-19
1-1/2"	150	60.7	98.55	40	48.58	48.11	40.5	18	35.0	4-19
2"	185	74.8	120.65	51	60.63	60.17	45.0	20	38.2	4-19
2-1/2"	185	89.6	139.70	63	73.38	72.85	51.0	24	45.0	4-19
3"	200	106.5	162.40	77	89.31	88.70	55.0	26	48.0	8-19
4"	229	133.0	190.50	102	114.76	114.10	64.0	28	57.5	8-19
5"	254	160.1	215.9	125	141.81	141.00	92.0	28	68.0	8-22
6"	285	187.1	241.30	156	168.83	168.00	87.0	32	76.8	8-22
8"	343	247.1	298.45	204	219.84	218.70	115.0	35	104.2	8-22
10"	406	305.0	352.0	266	273.81	272.67	150.0	42	128.6	12-25
12"	483	344.6	432.0	307	324.61	322.47	190.0	63	172.0	12-25